



## ST-02A



### Infrared Sensor (motion detector)

- ST-02A - Infrared Sensor (motion detector)
- EU size
- Approve: CE, ROHS
- PC (UV proof)
- Dual Detection Range: 160°
- Self Power Supply: Null + Live Line
- Two wire line
- 3 Years Warranty

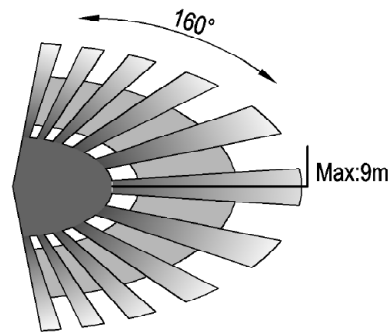
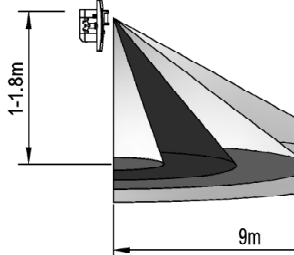

### Specifications

Detection Range	160°
Power Source	220-240V/AC
Rated Load	500W (incandescent lamp), 200W (energy-saving lamp)
Detection Distance	max.20m (<24 Celsius)
Time Delay	4-9m (<24 Celsius) (adjustable)
Ambient Light	<3-2000LUX (adjustable)
Installation Height	1-1.8m
Ingress Protection	IP65
Dimensions	80x80x32mm
Packaging	100PCS/CTN, Vol:0.0007m <sup>3</sup> , 0.18Kg

### Connection-Wire Diagram:

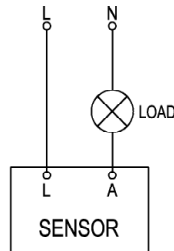

Figure 1.

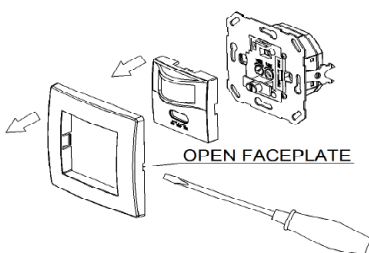

Figure 2.

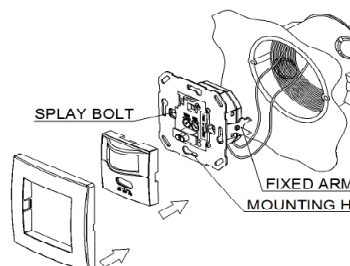

Figure 3.

